

Course and distance
down the river from the
pine to the Maple

- East . . . 16 ps.
- N. 66. E. . . 39
- N. 43. E. . . 19
- N. 23 E. . . 32
- N. 13 E. . . 12
- N. 4. W. . . 83

Line of Clearfield County

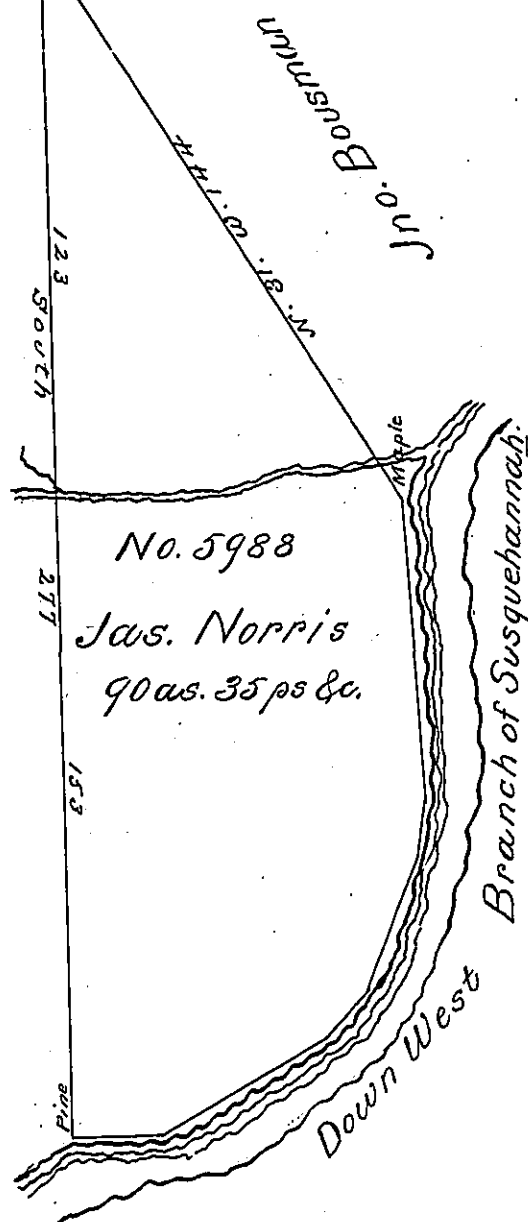

A Draught of a tract of Land Situate on the North side of the west Branch of Susquehanna river adjoining the line of Clearfield County Surveyed on the 22d day of April 1807 by virtue of Warrant (No. 5988) granted to James Harris dated the 28th day of March 1805 - Containing Ninety Acres and thirty five perches with the allowance of Six percent for Roads &c. -

David M^c Micken D.S.

To Richard T. Beech Esqr. }
Surveyor General }

IN TESTIMONY that the above is a copy of the original remaining on file in the Department of Internal Affairs of Pennsylvania, made conformably to an Act of Assembly approved the 16th day of February, 1833, I have hereunto set my Hand and caused the Seal of said Department to be affixed at Harrisburg, this second day of May 1899

James W. Pitts
Secretary of Internal Affairs.